

Pg 100

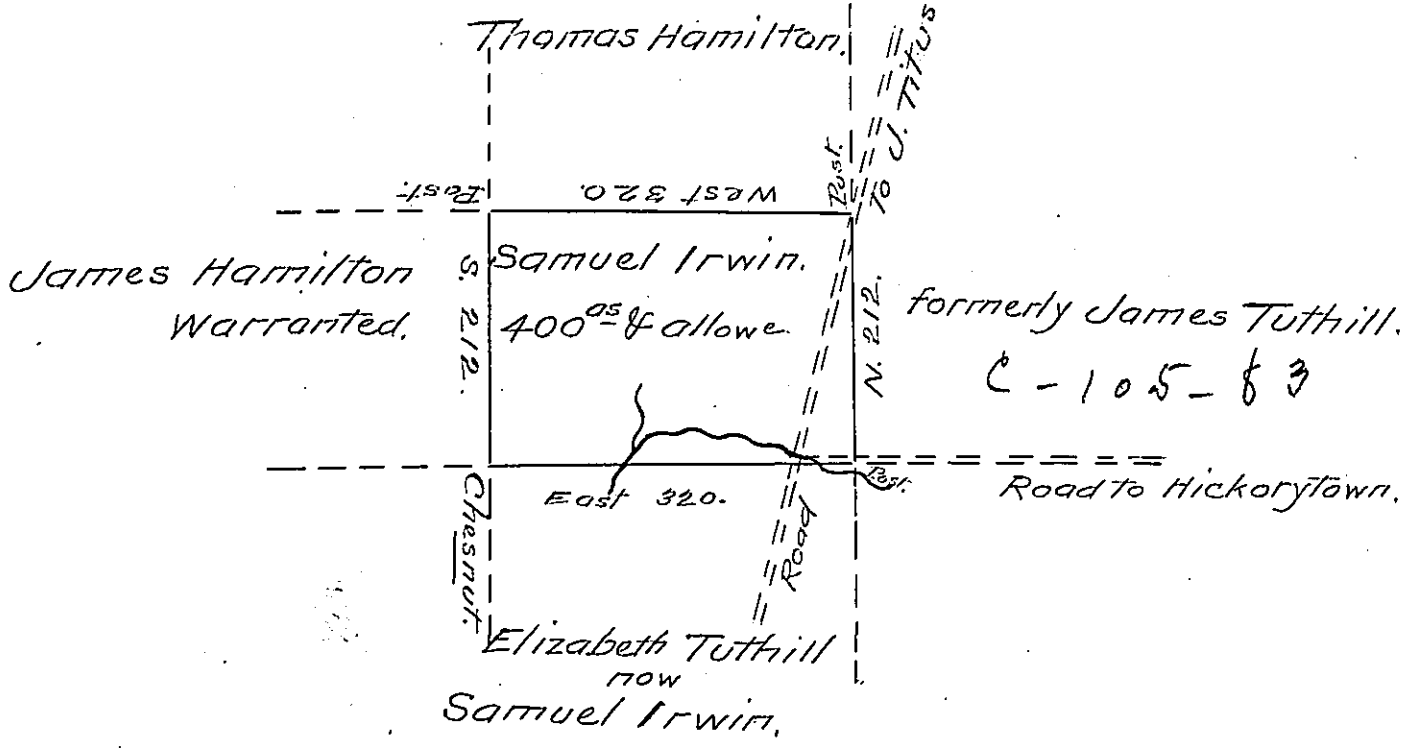

Pg 198

The Draft of a tract of Land in Cherry Tree Town-
 ship Venango County on the Waters of Sugar Creek,
 Surveyed 4th of May 1816 in pursuance of a War-
 rant granted to Samuel Irwin Dated the tenth
 day of January 1816.

A. McCalmont D.S.

To Richard T. Leech Esq. }
 Surveyor General }

IN TESTIMONY that the above is a copy of the original remaining on file in
 the Department of Internal Affairs of Pennsylvania, made
 conformably to an Act of Assembly approved the 16th day of
 February, 1833, I have hereunto set my Hand and caused
 the Seal of said Department to be affixed at Harrisburg,
 this twentieth day of April 1905.

Loae P. Brown
 Secretary of Internal Affairs.